

Grants Received for RV Park

Eldon Uptown Downtown	\$7,000
Southern Iowa Electric Cooperative	\$15,000
Wapello County Foundation	\$40,000
Wapello County	\$44,000
Wapello County In-Kind Work	\$140,000
Total	\$246,000

Costs to Construct RV Park – Provided by French Reneker Associates

Sitework, Utilities, Site Furnishings	\$599,057.00
Engineering	\$92,000.00
Contingencies	\$92,000.00
Mobilization	\$31,143.00
Total Cost	\$814,200.00

Wapello County Fair receives requests for RV Parking not only from our fair attendees, but also from those attending various fairground and other community events. We have a survey conducted by the Association of Iowa Fairs that asked the Iowa County Fair if they had or plan to build an RV Park on their fairgrounds. The overwhelming response from those Iowa County Fairs that have RV Parks recommended constructing RV Parks.

The Wapello County Fairgrounds has inadequate areas for RV parking facilities. We are limited in power availability. There are no other RV Park facilities in Eldon; the closest facility is Ottumwa Park. A modern RV Park with full electric, water and sewer connections will enhance our Wapello County Fair and encourage more usage of our fairgrounds. As well as enhancing overall tourism development in our Eldon Community, our RV Park will be an enhanced benefit for the American Gothic House and Visitor Center located in Eldon. Please see the following attached letter of support from Cari Nicely, administrator of the American Gothic House Visitor Center.

Our proposed RV Park/Camping Area is expected to add net income to the Wapello County Fair and enable the Wapello County Fairboard to make needed improvements to our fairgrounds.

Please help the Wapello County Fairboard by contributing to our project. Click the **Donate Link to Contribute**, or send your check to Wapello County Fair, Inc., P.O. Box 464, Eldon, IA 52554. **THANK YOU FOR YOUR SUPPORT!**

Donate



300 American Gothic Street
Eldon, Iowa 52554
641-652-3352
theamericangothichouse@gmail.com

October 21, 2022

To whom this may concern:

This letter is to support the Wapello County Fair Board on their endeavor to create an RV park in Eldon, Iowa.

As the administrator of the American Gothic House Center (AGHC), we have visitors arriving in RVs or with pull-type campers on a daily basis. Many times, the drivers ask if there is a campground nearby. Most times, I hear they are camping at Lake Lacey. If the visitors are coming to Eldon, which is Wapello County, why send them to Van Buren County to spend their money?

The American Gothic House was made famous by Iowan Grant Wood's painting, *American Gothic*, in 1930. It is on the national register of historic places and is an icon world-wide. In today's competitive field of non-profits and historical buildings, the little house in Eldon continues to rise to the top. We have had visitors from every single state in the United States as well as from over 100 different countries. The proposed RV park would give visitors a place to stay in Eldon with the opportunity to visit other area attractions and *to spend their tourism dollars in a town of under 1,000 residents!* Eldon currently does not have any type of hotel or facility to accommodate travelers overnight and being able to tell visitors in person or via phone about a local RV park is a win-win situation.

To the reverse, patrons of the RV park may give the AGHC additional visitors. Another thing I hear when people come in our doors is "Didn't even know this was here." An RV park could change that. The reciprocal promotion of community entities is crucial in a small town- especially in one where there residents have such a strong connection with each other, as well as with its incredible history.

As a seventeen year veteran of working in the Iowa county conservation system, I am aware first-hand of the importance of a campground facility to an area. The proposed RV park by the Wapello County Fair Board in Eldon is a necessary asset to this community.

Sincerely,

Cari Nicely

Cari Nicely
American Gothic House Center
Wapello County Conservation
Administrator

MARK	REVISION DESCRIPTION	DATE	BY
1			
2			
3			

DRAWING PATH: NAME: G:\2016\1615BWP\DRAWINGS\PLANS\Camping sites\NORTH SITE PLAN (s1).dwg - NORTH SITE 11x17
PLOTTED: 05/30/19 - 1:18pm - jeffm

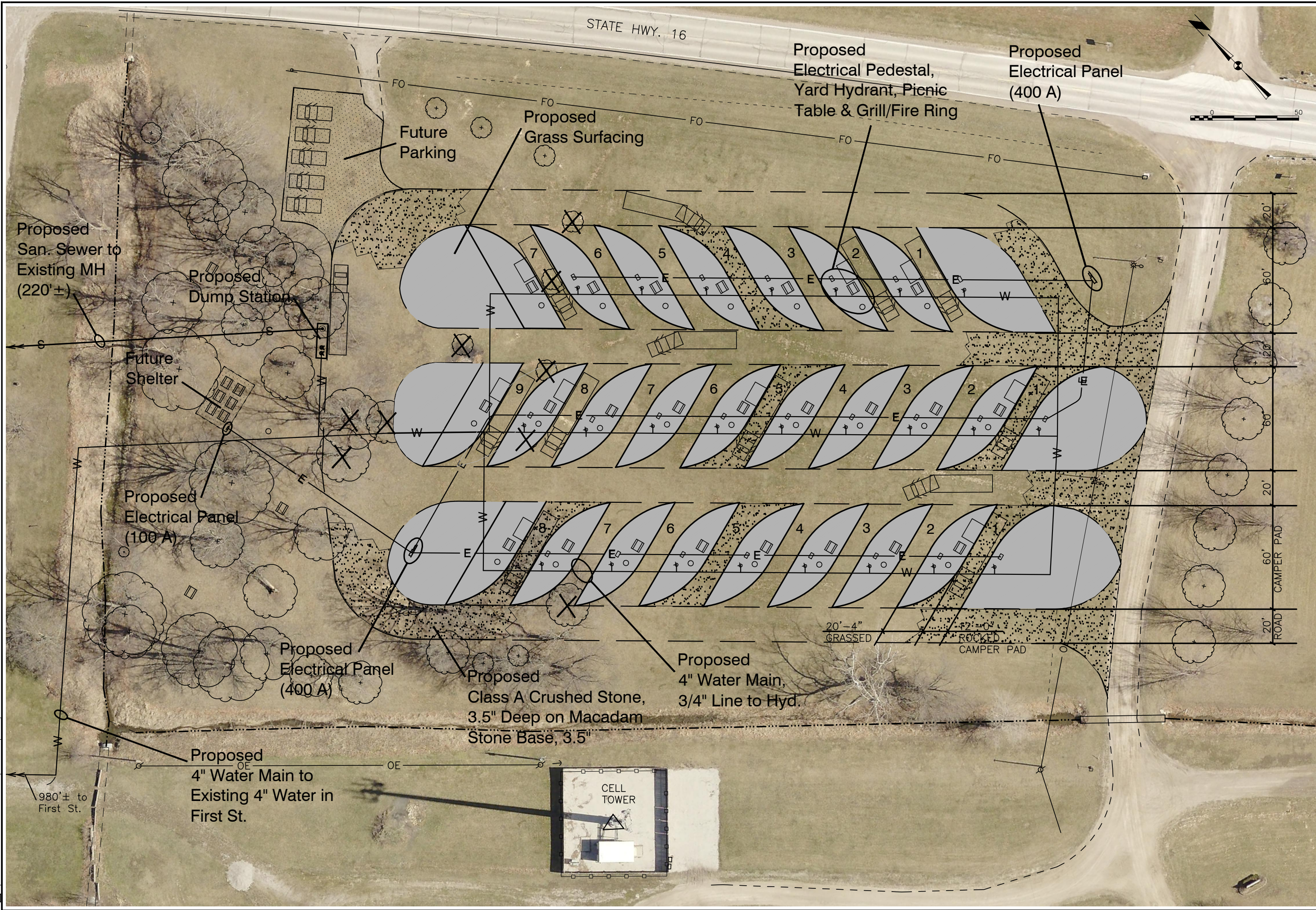

1501 S. Main Street
Fairfield, IA 52556
phone: (641) 472-5145
email: french-reneker.com
www.french-reneker.com

FRENCH-RENEKER-ASSOCIATES
ENGINEERS & SURVEYORS

NORTH SITE
CONCEPTUAL LAYOUT - 24 SITES

PROPOSED CAMPGROUND IMPROVEMENTS
WAPELLO CO. FAIR INC. ELDON, IOWA 2019

DATE: 05-24-19
PROJECT NO.: 16-159
Copyright © 2019

SHEET
3 OF
3